

GUTTERmaster

ALUMINIUM IN CONSTRUCTION

Shawclough Trading Estate,
Shawclough Road,
Rochdale,
Lancashire.
OL12 6ND

Tel: 01706 869550
Fax: 01706 869551

e-mail: technical@guttermaster
web: www.guttermaster.co.uk

PARTS LIST

QTY	LENGTH	PART NUMBER	DESCRIPTION	MATERIAL	COLOUR & FINISH
	3000 mm	TF-X3	TrimFix X3 Fascia (with square drip edge)	2.0mm Aluminum	RAL/BS
	100 mm	TF-X3-U	TrimFix X3 Internal Union (with square drip edge)	2.0mm Aluminum	RAL/BS

COMPONENT DETAILS

Dimension Description	Reference	Range (mm)	Dimension
Fascia height	Dim. A	25 - 1000	
Soffit depth	Dim. B	65 - 1000	
Offset distance to vent (optional)	Dim. Vp	n/a	

MATERIAL THICKNESS GUIDE

Guage	Dimension (mm)
1.5mm	25 - 239
2.0mm	240 - 539
2.5mm	540 - 689
3.0mm	690 - 939

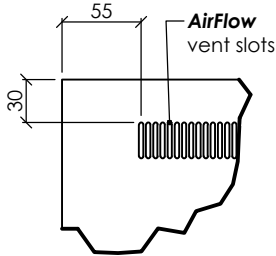
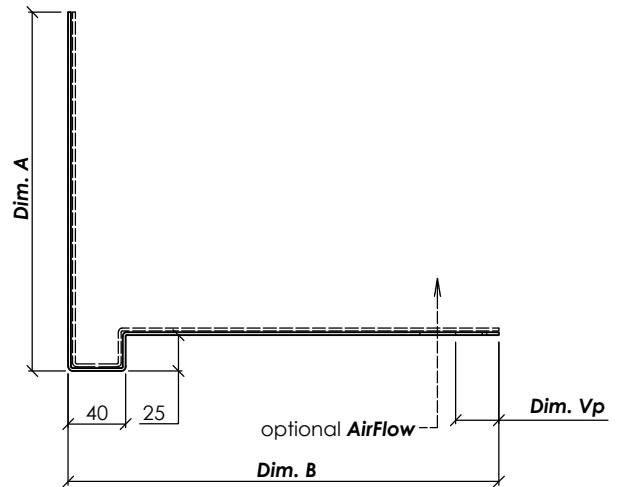
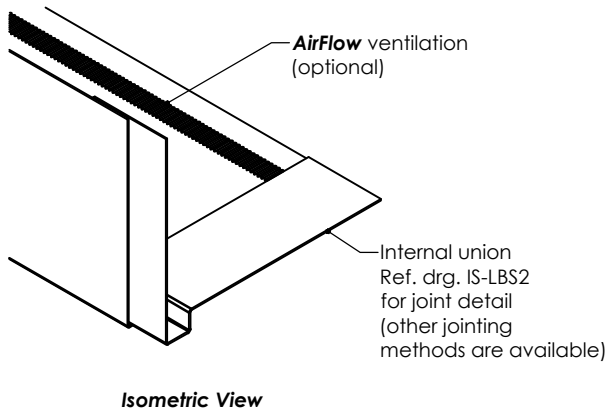

Optional **AirFlow** Ventilation

10000mmsq/m continuous ventilation - use 25x3mm slot for roof pitches over 15°
25000mmsq/m continuous ventilation - use 45x3mm slot for roof pitches of 15° or less

AirFlow Vent Detail

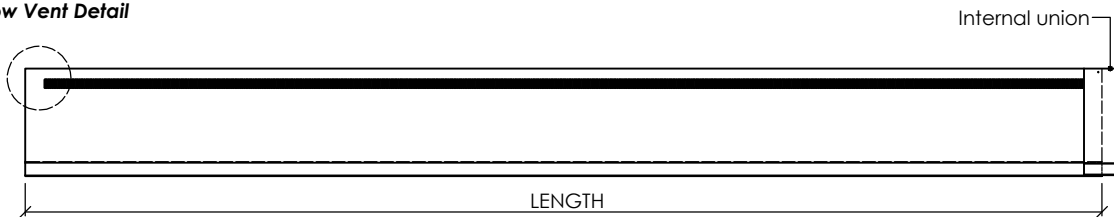

Client:				-	
Project:				STANDARD FASCIA PROFILES	
Title:				TRIMFIX X3 FASCIA PROFILE DETAIL	
Drawing Status:				ISSUE FOR INFORMATION	
Drawn by:	Checked by:	Date:	Approved by:	Date:	
A.S.	A.S.	21/09/2011			
Sheet size:	Scale:	Sheet No. (of sheets):	Drawing No:	Revision:	
A4	as shown	1 (of 1)	0001-TF-X3		