

# GUTTERmaster

ALUMINIUM IN CONSTRUCTION

Shawclough Trading Estate,  
Shawclough Road,  
Rochdale,  
Lancashire.  
OL12 6ND

Tel: 01706 869550  
Fax: 01706 869551

e-mail: technical@guttermaster  
web: www.guttermaster.co.uk

## PARTS LIST

QTY	LENGTH	PART NUMBER	DESCRIPTION	MATERIAL	COLOUR & FINISH
	3000 mm	TFX2	TrimFix X2 Fascia	2.0mm Aluminum	RAL/BS
	100 mm	TF-X2-U	TrimFix X2 Internal Union	2.0mm Aluminum	RAL/BS

## COMPONENT DETAILS

Dimension Description	Reference	Range (mm)	Dimension
<b>Fascia height</b>	<b>Dim. A</b>	<b>25 - 1000</b>	
<b>Soffit depth</b>	<b>Dim. B</b>	<b>25 - 1000</b>	
<b>Offset distance to vent (optional)</b>	<b>Dim. Vp</b>	<b>n/a</b>	

## MATERIAL THICKNESS GUIDE

Guage	Dimension (mm)
1.5mm	25 - 239
2.0mm	240 - 539
2.5mm	540 - 689
3.0mm	690 - 939

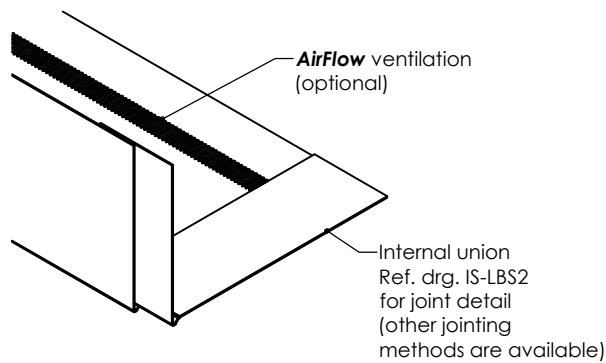

Isometric View

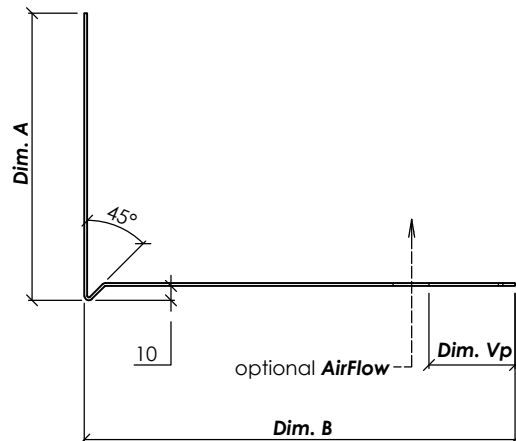

Profile Section  
(1 : 5)

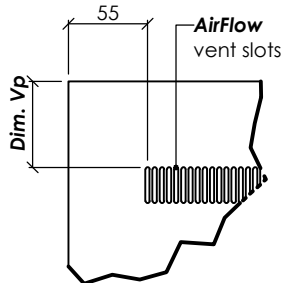

Optional **AirFlow** Ventilation

10000mmsq/m continuous ventilation - use 25x3mm slot for roof pitches over 15°  
25000mmsq/m continuous ventilation - use 45x3mm slot for roof pitches of 15° or less

**AirFlow Vent Detail (optional)**  
(1 : 5)

AirFlow Vent Detail

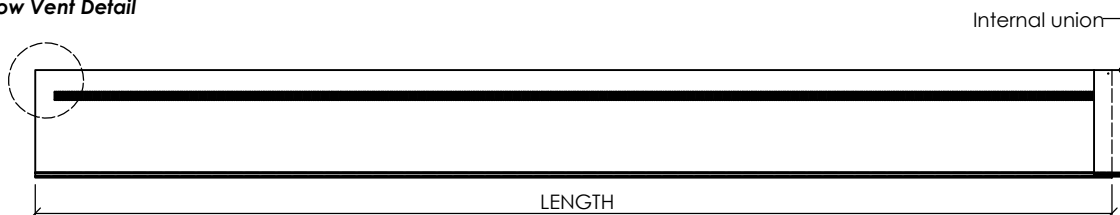

View on Plan  
(1 : 20)

Client:				-
Project:				STANDARD FASCIA PROFILES
Title:				TRIMFIX X2 FASCIA PROFILE DETAIL
Drawing Status:				ISSUE FOR INFORMATION
Drawn by:	Checked by:	Date:	Approved by:	Date:
A.S.	A.S.	21/09/2011		
Sheet size:	Scale:	Sheet No. (of sheets):	Drawing No:	Revision:
A4	as shown	1 (of 1)	0001-TF-X2	